

**DIN STANDARD  
NON-INSULATED RING TERMINALS (DIN46234)**

1. TERMINAL MATERIAL : COPPER
2. BRAZED SEAM
3. PLATING : ELECTRO TIN PLATED



DR3.5-0.5NB



DR4-1NB



DR5-2NB



DR6-6NB



DR8-10NB



DR12-16NB



DR10-25NB

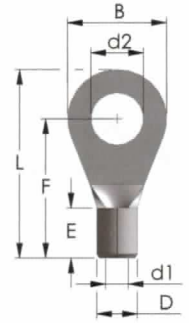

DIN STANDARD TERMINALS

WIRE RANGE AWG / mm <sup>2</sup>	ITEM NO.	UL	STUD SIZE d2	DIMENSIONS inch (mm)						
				B	L	F	E	D	d1	t
26~22 AWG 0.1~0.5 mm <sup>2</sup>	DR2-0.5NB	UL US	#2 (2.2)	.197 (5.0)	.492 (12.5)	.394 (10.0)	.157 (4.0)	.087 (2.2)	.039 (1.0)	.020 (0.5)
	DR2.5-0.5NB	UL US	#3 (2.7)	.197 (5.0)	.492 (12.5)	.394 (10.0)				
	DR3-0.5NB	UL US	#4 (3.2)	.197 (5.0)	.492 (12.5)	.394 (10.0)				
	DR3.5-0.5NB	UL US	#6 (3.7)	.236 (6.0)	.591 (15.0)	.472 (12.0)				
	DR4-0.5NB	UL US	#8 (4.3)	.256 (6.5)	.598 (15.2)	.472 (12.0)				
	DR5-0.5NB	UL US	#10 (5.3)	.315 (8.0)	.630 (16.0)	.472 (12.0)				
22~16 AWG 0.5~1.5 mm <sup>2</sup>	DR2.5-1NB	UL US	#3 (2.7)	.236 (6.0)	.551 (14.0)	.433 (11.0)	.197 (5.0)	.138 (3.5)	.063 (1.6)	.031 (0.8)
	DR3-1NB	UL US	#4 (3.2)	.236 (6.0)	.551 (14.0)	.433 (11.0)				
	DR3.5-1NB	UL US	#6 (3.7)	.236 (6.0)	.551 (14.0)	.433 (11.0)				
	DR4-1NB	UL US	#8 (4.3)	.315 (8.0)	.630 (16.0)	.472 (12.0)				
	DR5-1NB	UL US	#10 (5.3)	.394 (10.0)	.709 (18.0)	.512 (13.0)				
	DR6-1NB	UL US	1/4 (6.5)	.433 (11.0)	.807 (20.5)	.591 (15.0)				
	DR8-1NB	UL US	5/16 (8.4)	.551 (14.0)	.906 (23.0)	.630 (16.0)				
	DR10-1NB	UL US	3/8 (10.5)	.709 (18.0)	1.063 (27.0)	.709 (18.0)				
16~14AWG 1.5~2.5 mm <sup>2</sup>	DR3-2NB	UL US	#4 (3.2)	.236 (6.0)	.551 (14.0)	.433 (11.0)	.197 (5.0)	.161 (4.1)	.091 (2.3)	.031 (0.8)
	DR3.5-2NB	UL US	#6 (3.7)	.236 (6.0)	.551 (14.0)	.433 (11.0)				
	DR4-2NB	UL US	#8 (4.3)	.315 (8.0)	.630 (16.0)	.472 (12.0)				
	DR5-2NB	UL US	#10 (5.3)	.394 (10.0)	.748 (19.0)	.551 (14.0)				
	DR6-2NB	UL US	1/4 (6.5)	.433 (11.0)	.846 (21.5)	.630 (16.0)				
	DR8-2NB	UL US	5/16 (8.4)	.551 (14.0)	.945 (24.0)	.669 (17.0)				
	DR10-2NB	UL US	3/8 (10.5)	.709 (18.0)	1.063 (27.0)	.709 (18.0)				
	DR12-2NB	UL US	1/2 (13.0)	.866 (22.0)	1.339 (34.0)	.906 (23.0)				
12~10AWG 4~6 mm <sup>2</sup>	DR4-6NB	UL US	#8 (4.3)	.315 (8.0)	.709 (18.0)	.551 (14.0)	.236 (6.0)	.228 (5.8)	.142 (3.6)	.039 (1.0)
	DR5-6NB	UL US	#10 (5.3)	.394 (10.0)	.787 (20.0)	.591 (15.0)				
	DR6-6NB	UL US	1/4 (6.5)	.433 (11.0)	.846 (21.5)	.630 (16.0)				
	DR8-6NB	UL US	5/16 (8.4)	.551 (14.0)	1.024 (26.0)	.748 (19.0)				
	DR10-6NB	UL US	3/8 (10.5)	.709 (18.0)	1.181 (30.0)	.827 (21.0)				
	DR12-6NB	UL US	1/2 (13.0)	.866 (22.0)	1.417 (36.0)	1.043 (26.5)				
8 A.W.G. 10 mm <sup>2</sup>	DR5-10NB	UL US	#10 (5.3)	.394 (10.0)	.827 (21.0)	.630 (16.0)	.315 (8.0)	.276 (7.0)	.177 (4.5)	.043 (1.1)
	DR6-10NB	UL US	1/4 (6.5)	.433 (11.0)	.886 (22.5)	.669 (17.0)				
	DR8-10NB	UL US	5/16 (8.4)	.551 (14.0)	1.063 (27.0)	.787 (20.0)				
	DR10-10NB	UL US	3/8 (10.5)	.709 (18.0)	1.181 (30.0)	.827 (21.0)				
	DR12-10NB	UL US	1/2 (13.0)	.866 (22.0)	1.339 (34.0)	.906 (23.0)				
	DR16-10NB	UL US	5/8 (15.9)	1.102 (28.0)	1.929 (49.0)	1.378 (35.0)				
6 A.W.G. 16 mm <sup>2</sup>	DR5-16NB	UL US	#10 (5.3)	.433 (11.0)	1.004 (25.5)	.787 (20.0)	.394 (10.0)	.335 (8.5)	.228 (5.8)	.047 (1.2)
	DR6-16NB	UL US	1/4 (6.5)	.433 (11.0)	1.004 (25.5)	.787 (20.0)				
	DR8-16NB	UL US	5/16 (8.4)	.551 (14.0)	1.142 (29.0)	.866 (22.0)				
	DR10-16NB	UL US	3/8 (10.5)	.709 (18.0)	1.299 (33.0)	.945 (24.0)				
	DR12-16NB	UL US	1/2 (13.0)	.866 (22.0)	1.457 (37.0)	1.024 (26.0)				
	DR16-16NB	UL US	5/8 (15.9)	1.102 (28.0)	1.929 (49.0)	1.378 (35.0)				
4 A.W.G. 25 mm <sup>2</sup>	DR5-25NB	UL US	#10 (5.3)	.472 (12.0)	1.220 (31.0)	.984 (25.0)	.433 (11.0)	.425 (10.8)	.295 (7.5)	.059 (1.5)
	DR6-25NB	UL US	1/4 (6.5)	.472 (12.0)	1.220 (31.0)	.984 (25.0)				
	DR8-25NB	UL US	5/16 (8.4)	.630 (16.0)	1.299 (33.0)	.984 (25.0)				
	DR10-25NB	UL US	3/8 (10.5)	.709 (18.0)	1.378 (35.0)	1.024 (26.0)				
	DR12-25NB	UL US	1/2 (13.0)	.866 (22.0)	1.654 (42.0)	1.220 (31.0)				
	DR16-25NB	UL US	5/8 (15.9)	1.102 (28.0)	1.929 (49.0)	1.378 (35.0)				