



R8-6LNB



R14-6LNB



R22-6NB



R38-6LNB

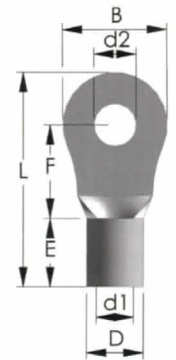

8~38mm²

WIRE RANGE AWG / mm ²	ITEM NO.	UL	STUD SIZE d2	DIMENSIONS inch (mm)						
				B	F	L	E	D	d1	t
8 A.W.G. 8 mm ²	R8-3.5NB		#6 (3.7)	.346 (8.8)	.382 (9.7)	.886 (22.5)	.335 (8.5)	.280 (7.1)	.177 (4.5)	.047 (1.2)
	R8-4SNB		#8 (4.3)	.346 (8.8)	.382 (9.7)	.886 (22.5)				
	R8-4LNB	UL	#8 (4.3)	.472 (12.0)	.382 (9.7)	.925 (23.5)				
	R8-5SNB		#10 (5.3)	.346 (8.8)	.382 (9.7)	.886 (22.5)				
	R8-5MNB	UL	#10 (5.3)	.472 (12.0)	.382 (9.7)	.925 (23.5)				
	R8-5LNB	UL	#10 (5.3)	.591 (15.0)	.543 (13.8)	1.161 (29.5)				
	R8-6SNB	UL	1/4 (6.5)	.472 (12.0)	.382 (9.7)	.925 (23.5)				
	R8-6LNB	UL	1/4 (6.5)	.591 (15.0)	.543 (13.8)	1.161 (29.5)				
	R8-8NB	UL	5/16 (8.4)	.591 (15.0)	.543 (13.8)	1.161 (29.5)				
	R8-10NB	UL	3/8 (10.5)	.591 (15.0)	.543 (13.8)	1.161 (29.5)				
	R8-12NB	UL	1/2 (13.0)	.787 (20.0)	.591 (15.0)	1.319 (33.5)				
	R8-14NB	UL	9/16 (15.0)	1.244 (31.6)	1.008 (25.6)	1.949 (49.5)				
	R8-16NB	UL	5/8 (17.0)	1.244 (31.6)	1.008 (25.6)	1.949 (49.5)				
	R8-18NB	UL	11/16 (19.0)	1.244 (31.6)	1.008 (25.6)	1.949 (49.5)				
R8-20NB	UL	3/4 (21.0)	1.244 (31.6)	1.008 (25.6)	1.949 (49.5)					
6 A.W.G. 14 mm ²	R14-4NB	UL	#8 (4.3)	.472 (12.0)	.524 (13.3)	1.150 (29.2)	.413 (10.5)	.354 (9.0)	.228 (5.8)	.059 (1.5)
	R14-5NB	UL	#10 (5.3)	.472 (12.0)	.524 (13.3)	1.150 (29.2)				
	R14-6SNB	UL	1/4 (6.5)	.472 (12.0)	.524 (13.3)	1.150 (29.2)				
	R14-6LNB	UL	1/4 (6.5)	.630 (16.0)	.559 (14.2)	1.280 (32.5)				
	R14-8NB	UL	5/16 (8.4)	.630 (16.0)	.559 (14.2)	1.280 (32.5)				
	R14-10NB	UL	3/8 (10.5)	.630 (16.0)	.559 (14.2)	1.280 (32.5)				
	R14-12NB	UL	1/2 (13.0)	.866 (22.0)	.780 (19.8)	1.614 (41.0)				
	R14-14NB	UL	9/16 (15.0)	1.244 (31.6)	.996 (25.3)	2.008 (51.0)				
	R14-16NB	UL	5/8 (17.0)	1.244 (31.6)	.996 (25.3)	2.008 (51.0)				
	R14-18NB	UL	11/16 (19.0)	1.244 (31.6)	.996 (25.3)	2.008 (51.0)				
R14-20NB	UL	3/4 (21.0)	1.244 (31.6)	.996 (25.3)	2.008 (51.0)					
4 A.W.G. 22 mm ²	R22-4NB	UL	#8 (4.3)	.480 (12.2)	.594 (15.1)	1.280 (32.5)	.472 (12.0)	.453 (11.5)	.303 (7.7)	.067 (1.7)
	R22-5SNB	UL	#10 (5.3)	.480 (12.2)	.594 (15.1)	1.280 (32.5)				
	R22-5LNB	UL	#10 (5.3)	.650 (16.5)	.531 (13.5)	1.291 (32.8)				
	R22-6SNB	UL	1/4 (6.5)	.480 (12.2)	.594 (15.1)	1.280 (32.5)				
	R22-6LNB	UL	1/4 (6.5)	.650 (16.5)	.531 (13.5)	1.291 (32.8)				
	R22-8NB	UL	5/16 (8.4)	.650 (16.5)	.531 (13.5)	1.291 (32.8)				
	R22-10NB	UL	3/8 (10.5)	.650 (16.5)	.531 (13.5)	1.291 (32.8)				
	R22-10LNB	UL	3/8 (10.5)	.689 (17.5)	.630 (16.0)	1.445 (36.7)				
	R22-12NB	UL	1/2 (13.0)	.866 (22.0)	.776 (19.7)	1.673 (42.5)				
	R22-14NB	UL	9/16 (15.0)	1.181 (30.0)	.953 (24.2)	2.008 (51.0)				
	R22-16NB	UL	5/8 (17.0)	1.181 (30.0)	.953 (24.2)	2.008 (51.0)				
	R22-18NB	UL	11/16 (19.0)	1.181 (30.0)	.953 (24.2)	2.008 (51.0)				
R22-20NB	UL	3/4 (21.0)	1.181 (30.0)	.953 (24.2)	2.008 (51.0)					
2 A.W.G. 38 mm ²	R38-5NB	UL	#10 (5.3)	.602 (15.3)	.685 (17.4)	1.535 (39.0)	.551 (14.0)	.524 (13.3)	.370 (9.4)	.071 (1.8)
	R38-6SNB	UL	1/4 (6.5)	.602 (15.3)	.685 (17.4)	1.535 (39.0)				
	R38-6LNB	UL	1/4 (6.5)	.866 (22.0)	.697 (17.7)	1.681 (42.7)				
	R38-8SNB	UL	5/16 (8.4)	.602 (15.3)	.685 (17.4)	1.535 (39.0)				
	R38-8LNB	UL	5/16 (8.4)	.866 (22.0)	.697 (17.7)	1.681 (42.7)				
	R38-10SNB	UL	3/8 (10.5)	.602 (15.3)	.685 (17.4)	1.535 (39.0)				
	R38-10LNB	UL	3/8 (10.5)	.866 (22.0)	.697 (17.7)	1.681 (42.7)				
	R38-12NB	UL	1/2 (13.0)	.866 (22.0)	.697 (17.7)	1.681 (42.7)				
	R38-14NB	UL	9/16 (15.0)	1.181 (30.0)	.917 (23.3)	2.047 (52.0)				
	R38-16NB	UL	5/8 (17.0)	1.181 (30.0)	.917 (23.3)	2.047 (52.0)				
	R38-18NB	UL	11/16 (19.0)	1.181 (30.0)	.917 (23.3)	2.047 (52.0)				
	R38-20NB	UL	3/4 (21.0)	1.181 (30.0)	.917 (23.3)	2.047 (52.0)				