

ITEM NO.	FORM	WIRE GAGE	DIM 'B'	DIM 'C'	DIM 'D'	DIM 'E'	DIM 'F'	DIM 'G'	PLATING: SEE NOTE 2
45750111	CHAIN	18-20	.142±.012 (3.60±0.30)	.177±.016 (4.50±0.40)	.035 (0.90)	.075±.012 (1.90±0.30)	.091±.016 (2.30±0.40)	.020 (0.50)	1 TIN OVER NICKEL
45750112	LOOSE	16	.142±.012 (3.60±0.30)	.177±.016 (4.50±0.40)	.035 (0.90)	.091±.012 (2.30±0.30)	.106±.016 (2.70±0.40)	.024 (0.60)	
45750121	CHAIN	18-20	.142±.012 (3.60±0.30)	.177±.016 (4.50±0.40)	.035 (0.90)	.075±.012 (1.90±0.30)	.091±.016 (2.30±0.40)	.020 (0.50)	2 SELECT GOLD OVER NICKEL
45750122	LOOSE	16	.142±.012 (3.60±0.30)	.177±.016 (4.50±0.40)	.035 (0.90)	.091±.012 (2.30±0.30)	.106±.016 (2.70±0.40)	.024 (0.60)	

NOTES:

- MATERIAL: COPPER ALLOY .0080/(0.203) THICK
- FINISH:
 - .000100/(0.00254) MIN, BRIGHT TIN OVER .000050/(0.00127) MIN NICKEL OVERALL.
 - .000030/(0.00076) MIN, SELECT GOLD IN CONTACT AREA AND .000100/(0.00254) MIN, SELECT MATTE TIN IN CRIMP AREA OVER .000050/(0.00127) MIN, NICKEL OVERALL.
 GOLD PLATING RECOMMENDED FOR APPLICATIONS WHERE FRETTING CORROSION IS A CONCERN.
- PRODUCT SPECIFICATION: PS-45750-001
- PACKAGING SPECIFICATION : PK-45750-001 FOR CHAIN TERMINALS
PK-5556-003 FOR LOOSE TERMINALS
- TERMINAL FOR USE WITH 5557, 42474, 44516, 43760, AND 30067 SERIES HOUSINGS.
- WHEN TERMINALS ARE INSTALLED IN THE HOUSING, THE WIRES ARE TO BE DRESSED IN SUCH A MANNER TO ALLOW THE TERMINALS TO FLOAT FREELY IN THE POCKET.
- THIS TERMINAL IS DESIGNED FOR SINGLE WIRE CRIMPING.

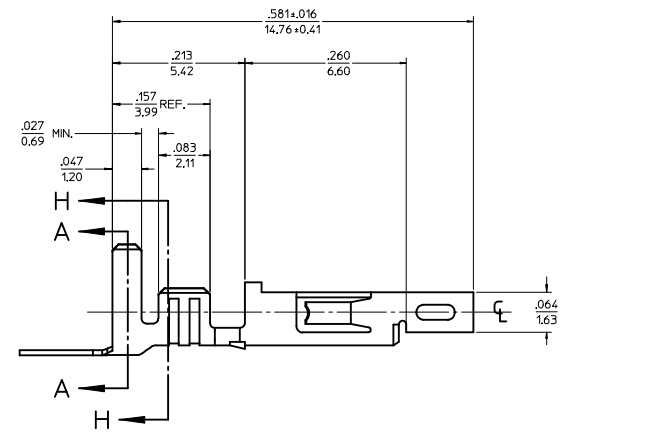
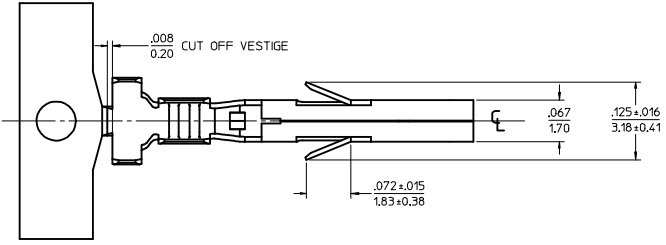
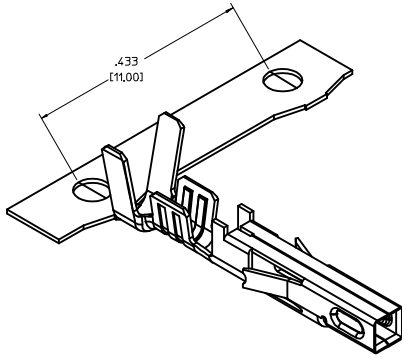

LEGEND

45750 * * 1 *

BASE NUMBER: 45750

FORM: 1 = CHAIN, 2 = LOOSE

WIRE GAGE: 1 = 18-20, 3 = 16

PLATING (SEE NOTE 2): 1 = TIN OVER NICKEL, 2 = SELECT GOLD

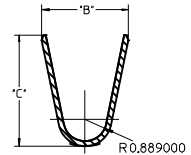
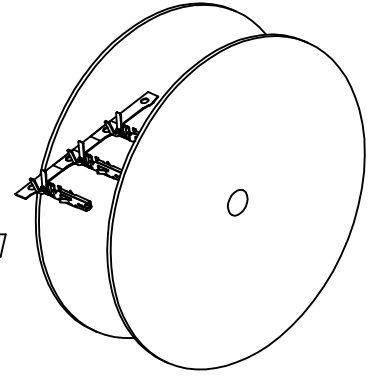
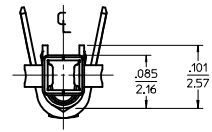

SECTION A-A

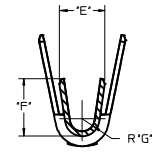

SECTION H-H

RoHS COMPLIANT

UPDATE .050 DIM EEC NO: UCP2014-4406 DRAWN BY: CHYD:IBELL APPROVED: SMITH 2014/04/25 2015/07/17	QUALITY SYMBOLS ∇=0 ∇=0 ∇=0	GENERAL TOLERANCES (UNLESS SPECIFIED): mm INCH		DIMENSION STYLE IN/MM	SCALE 10:1	DESIGN UNITS INCH	THIRD ANGLE PROJECTION
		4 PLACES ±.010 3 PLACES ±.010 2 PLACES ±0.25 ±.014 1 PLACE ±0.36 ±.014 0 PLACE ±.010 ±.014	DRAWN BY: SML CHECKED BY: MMD APPROVED BY: AP DATE: 2004/01/30 DATE: 2004/01/30 DATE: 2004/02/05	MATERIAL NO. SD-45750-001 DOCUMENT NO. SD-45750-001		SHEET NO. 1 OF 1	

THIS DRAWING CONTAINS INFORMATION THAT IS PROPRIETARY TO MOLEX INCORPORATED AND SHOULD NOT BE USED WITHOUT WRITTEN PERMISSION

**MINI-FIT JR. PLUS HCS SERIES
DUAL ROW**



45750
FEMALE CRIMP TERMINAL

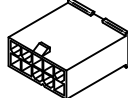

5559-03P1
PLUG W/O MTG. EARS

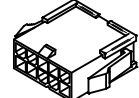

5559-03P
PLUG W/ MTG. EARS



46012
MALE CRIMP TERMINAL

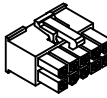

5557-03R2
RECEPTACLE

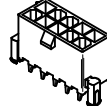

46015
VERTICAL HEADER
W/ MTG. PEGS

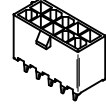

46015
VERTICAL HEADER
W/O MTG. PEGS

(WITH AND WITHOUT
DRAIN HOLES)

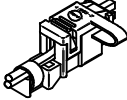

41995-0
STRAIN RELIEF
(FOR MINI-FIT JR. ONLY)

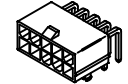

5569-03A2
RIGHT ANGLE HEADER
W/ MTG. PEGS

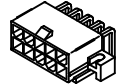

5569-03A1
RIGHT ANGLE HEADER
W/ MTG. FLANGES

**MINI-FIT JR. PLUS HCS SERIES
(MAKE-FIRST/BREAK-LAST)**

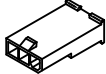

5559-03P3
PLUG W/O MTG. EARS



5559-03P2
PLUG W/ MTG. EARS

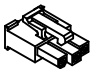

5557-03R2
RECEPTACLE



46014
VERTICAL HEADER
W/ MTG. PEGS

(WITH AND WITHOUT
DRAIN HOLES)



5569-03A4
RIGHT ANGLE HEADER
W/ MTG. PEGS



5569-03A3
RIGHT ANGLE HEADER
W/ MTG. FLANGES

**MINI-FIT JR. PLUS HCS SERIES
SINGLE ROW**

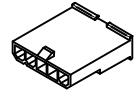

5559-03P3
PLUG W/O MTG. EARS

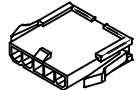

5559-03P2
PLUG W/ MTG. EARS

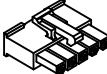

5557-03R2
RECEPTACLE



46014
VERTICAL HEADER
W/ MTG. PEGS

(WITH AND WITHOUT
DRAIN HOLES)



5569-03A4
RIGHT ANGLE HEADER
W/ MTG. PEGS



5569-03A3
RIGHT ANGLE HEADER
W/ MTG. FLANGES



42232-00
POLARIZING KEY FOR
MINI-FIT JR., B.M.I. & T.P.A.
RECEPTABLES ONLY.

MINI-FIT PLUS HCS B.M.I. SERIES

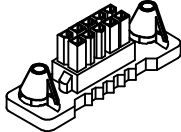

42474-0000
BLIND MATING RECEPTACLE
(DRAWER CONNECTOR)

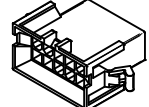

42475-0000
BLIND MATE PLUG
W/ MTG. EARS

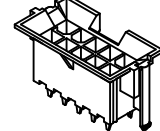

46011
BLIND MATING VERTICAL HEADER
(BOARD-TO-BOARD)

(WITH AND WITHOUT
DRAIN HOLES)

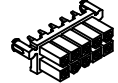

46010
VERTICAL RECEPTACLE HEADER
(BOARD-TO-BOARD)

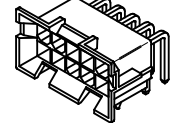

A-42404-0000
BLIND MATING RIGHT ANGLE HEADER
(BOARD-TO-BOARD)

MINI-FIT PLUS HCS T.P.A. SERIES

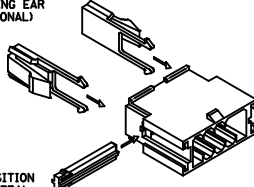

43130-0001
SNAP-ON
MOUNTING EAR
(OPTIONAL)

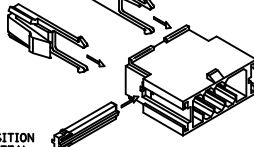

30072-00
TERMINAL POSITION
ASSURANCE (TPA)



30068-00
PLUG

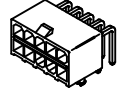

30070-00
RIGHT ANGLE HEADER
WITH MTG. PEGS

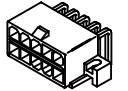

30070-A
RIGHT ANGLE HEADER
W/ MTG. FLANGES

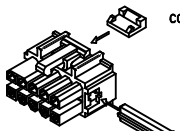

30071-00
CONNECTOR POSITION
ASSURANCE (CPA)

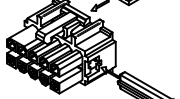

30067-00
RECEPTACLE

INITIAL RELEASE IEC NO. UCF2006-2550 DRAWN: GREGORI 2006/05/12 CHYD: 2006/05/13 APPR.: COMERCI 2006/05/15 REV: DESCRIPTION	QUALITY SYMBOLS ▽=0 ▽=0		GENERAL TOLERANCES (UNLESS SPECIFIED)		DIMENSION STYLE IN/MM	SCALE DATE	DESIGN UNITS METRIC	THIRD ANGLE PROJECTION
	4 PLACES	±	---	±	---	DRAWN BY	DATE	TITLE
	3 PLACES	±	---	±	---	CHECKED BY	DATE	
	2 PLACES	±	---	±	---	APPROVED BY	DATE	
1 PLACE	±	---	±	---	JCOMERCI			
ANGULAR ±---°			DRAFT WHERE APPLICABLE MUST REMAIN WITHIN DIMENSIONS		WATERL. NO. SEE ABOVE		DOCUMENT NO. SDIN-45750-001	
MOLEX INCORPORATED					MOLEX INCORPORATED		SHEET NO. 1 OF 1	
THIS DRAWING CONTAINS INFORMATION THAT IS PROPRIETARY TO MOLEX INCORPORATED AND SHOULD NOT BE USED WITHOUT WRITTEN PERMISSION								