

Socket: Straight PCB Termination

Buchse: Gerader Leiterplattenanschluss

Dimensions
Abmessungen

Socket Connector, Front View
Buchsensteckverbinder, Frontansicht

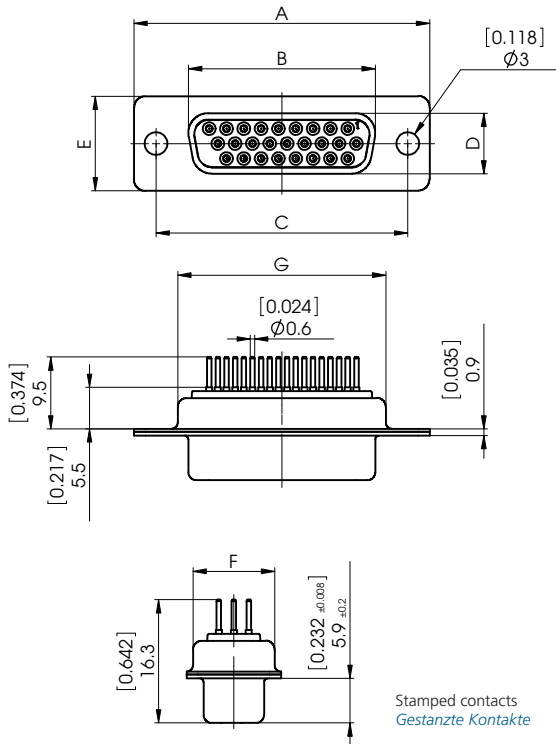

15 contacts
15 Kontakte

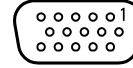

26 contacts
26 Kontakte

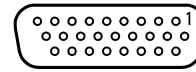

44 contacts
44 Kontakte

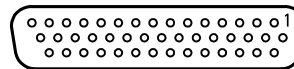

62 contacts
62 Kontakte

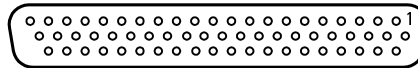

78 contacts
78 Kontakte

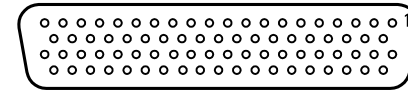

Stamped contacts
Gestanzte Kontakte

Order Number Bestellnummer	Shell Size Gehäusegröße	Number of Contacts Polzahl	A	B	C	D	E	F	G	H	J
			±0,4 (±0.016)	-0,2 (-0.008)	±0,15 (±0.006)	-0,2 (-0.008)	±0,4 (±0.016)	±0,3 (±0.012)	±0,3 (±0.012)		
CT09-15S1	1	15	30,8 (1.213)	16,4 (0.646)	25,0 (0.984)	8,0 (0.315)	12,5 (0.492)	10,8 (0.425)	19,3 (0.760)	7,10 (0.280)	2,29 (0.090)
CT15-26S1	2	26	39,1 (1.539)	24,7 (0.972)	33,3 (1.311)	8,0 (0.315)	12,5 (0.492)	10,8 (0.425)	27,5 (1.083)	6,80 (0.268)	2,29 (0.090)
CT25-44S1	3	44	53,0 (2.087)	38,5 (1.516)	47,0 (1.852)	8,0 (0.315)	12,5 (0.492)	10,8 (0.425)	41,3 (1.626)	7,00 (0.276)	2,29 (0.090)
CT37-62S1	4	62	69,3 (2.728)	54,9 (2.161)	63,5 (2.500)	8,0 (0.315)	12,5 (0.492)	10,8 (0.425)	57,7 (2.272)	7,00 (0.276)	2,42 (0.095)
CT50-78S1	5	78	66,9 (2.634)	52,5 (2.067)	61,1 (2.406)	10,8 (0.425)	15,4 (0.606)	13,7 (0.539)	55,3 (2.177)	7,60 (0.299)	2,42 (0.095)

Dimensions in mm (inch) - Abmessungen in mm (inch)

PCB Hole Pattern (Mounting Side)
Leiterplattenlochbild (Bestückungsseite)

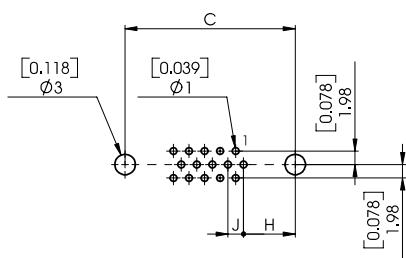

Hole Pattern 15 Contacts
Lochbild 15-polig

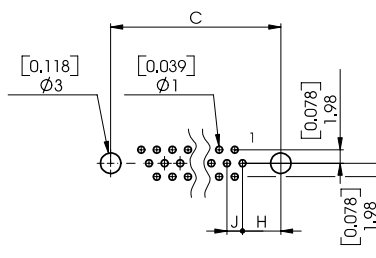

Hole Pattern 26, 44 and 62 Contacts
Lochbild 26-, 44- und 62-polig

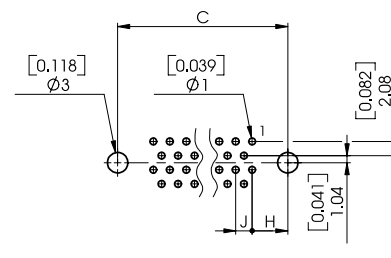

Hole Pattern 78 Contacts
Lochbild 78-polig