



preci-dip

WWW.PRECIDIP.COM TEL +41 32 421 04 00 SALES@PRECIDIP.COM

SOCKET CONNECTORS 2.54 mm

MATING PIN Ø 0.76 mm / SINGLE ROW / DOUBLE ROW / SURFACE MOUNT

Socket connectors, SMD perpendicular mount.

TECHNICAL SPECIFICATIONS (FOR GENERAL SPECS, SEE PAGE 43)

INSULATOR	Black glass filled polyester PCT-GF30-FR
FLAMMABILITY	UL 94V-0
SLEEVE	Brass CuZn36Pb3 (C36000)
CONTACT CLIP (6 FINGER)	Beryllium copper (C17200)
MATING PINS	Ø 0.70 to 0.90 mm, ∇ 0.635 mm
FORCES	1.2 N typ. insertion 0.6 N typ. withdrawal (polished steel gauge Ø 0.76 mm)
MECHANICAL LIFE	Min. 500 cycles
RATED CURRENT	3 A
CONTACT RESISTANCE	Max. 10 mΩ
DIELECTRIC STRENGTH	Min. 1'000 V _{RMS}
COPLANARITY	Max. 0.1 mm (measured on 25 mm long connectors)
SMD TERMINATIONS	

For corresponding pin connectors, see pages 109-119.

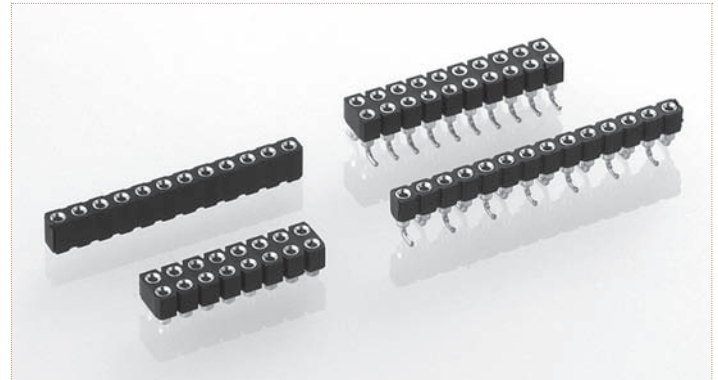

Other plating on request (see page 178 for plating specs).

NNN number of poles. Replace **NNN** with the requested number of poles, e.g. 803-87-**NNN**-30-002101 for a double row version with 16 pins becomes 803-87-**016**-30-002101.

ORDERING INFORMATION ROHS COMPLIANT PARTS

PP PLATING CODE	SLEEVE	CLIP
87	Tin	Flash gold
83	Tin	0.75 µm gold

801-PP-NNN-30-480101

SMD socket connector, single row, perpendicular mount with self-levelling floating contacts

AVAILABILITY FROM	2 to 12 contacts (standard number of contacts: 12) For connectors having more than 9 contacts, the coplanarity issue is to be addressed specifically
-------------------	---



T & R Packaging

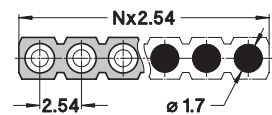
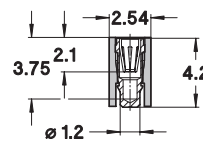

803-PP-NNN-30-480101

SMD socket connector, double row, perpendicular mount with self-levelling floating contacts

AVAILABILITY FROM	4 to 64 contacts (standard number of contacts: 64) For connectors having more than 9 contacts per row, the coplanarity issue is to be addressed specifically
-------------------	---



T & R Packaging

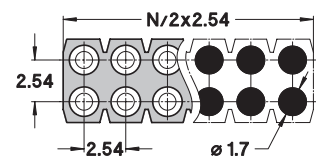
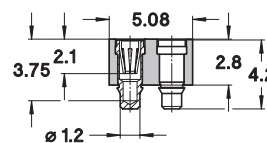

801-PP-NNN-30-002101

SMD socket connector, single row, perpendicular mount with gull-wing terminations

AVAILABILITY FROM	3 to 64 contacts (standard number of contacts: 64) For connectors having more than 9 contacts, the coplanarity issue is to be addressed specifically
-------------------	---



T & R Packaging

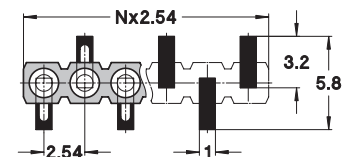
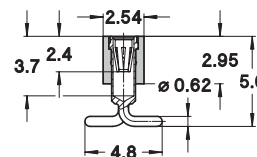

803-PP-NNN-30-002101

SMD socket connector, double row, perpendicular mount with gull-wing terminations

AVAILABILITY FROM	4 to 72 contacts (standard number of contacts: 40 and 72) For connectors having more than 9 contacts per row, the coplanarity issue is to be addressed specifically
-------------------	--



T & R Packaging

