

## FEATURES AND SPECIFICATIONS

### Features and Benefits

- High current
- Fully polarized
- Positive locks
- Low engagement force
- Wire-to-wire
- Grounding contacts available

### Reference Information

Product Specification: PS-42815-0001  
 Packaging: Reel  
 UL File No.: E29179  
 CSA File No.: LR19980  
 TUV License No.: R9751144  
 Use With: **42818** and **43938** plug housings  
 Designed In: Millimeters

### Electrical

Voltage: 600V  
 Current: 50.0A max.\*  
 Contact Resistance: 1.5mΩ max.  
 Dielectric Withstanding Voltage: 2200V  
 Insulation Resistance: 1000 MΩ min.

### Mechanical

Contact Insertion Force: 29.4N max.  
 Contact Retention to Housing: 98.1N min.  
 Wire Pull-Out Force: 12 AWG—304.0N  
 Mating Force: 29.4N max.  
 Unmating Force: 4.9N min.  
 Normal Force: 1.96N min.  
 Durability: 30 cycles

### Physical

Contact: Copper Alloy, UL 94V-0  
 Plating: Tin/Lead over Nickel  
 Operating Temperature: -40 to +105°C  
 Wire gauge: 8, 10, 12 AWG  
 Insulation Diameter:  
 10 to 12 AWG—3.50 to 5.50mm (.138 to .209")  
 † 8 AWG—5.00 to 6.75mm (.197 to .266")

\* Depending on circuit size and wire gauge. Please refer to product specification.

† Wire insulation not to be crimped and insulation grip area should be formed to certain wire strands only.



# 10.00mm (.393") Pitch Mini-Fit, Sr.™ Terminal

## 42817 Male

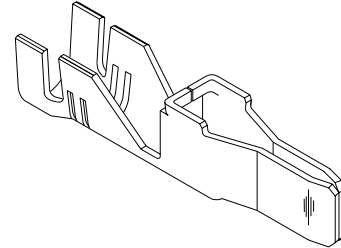

## CATALOG DRAWING (FOR REFERENCE ONLY)

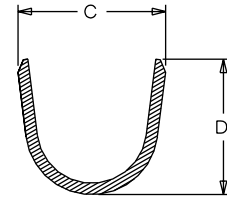
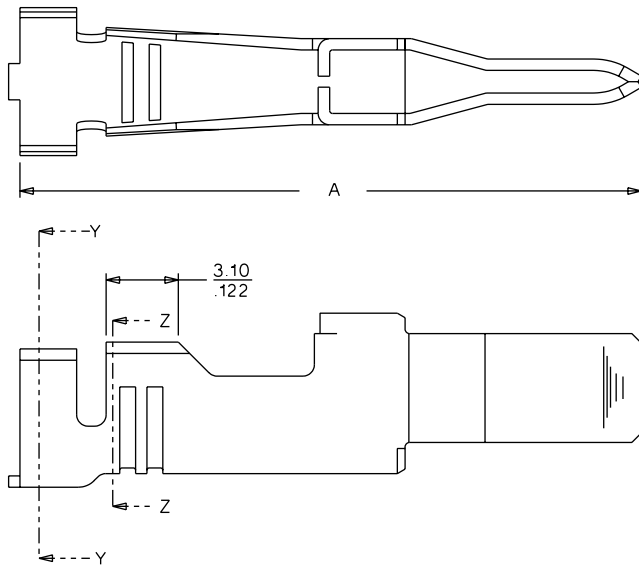

SECTION Y-Y

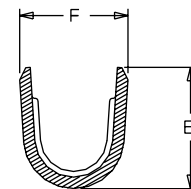
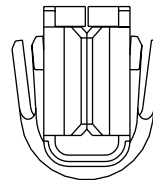

SECTION Z-Z

## ORDERING INFORMATION AND DIMENSIONS

Type	Order No.	Wire Gauge	Dimension				
			A	C	D	E	F
Standard Contacts	42817-0011	10 and 12 AWG	1.087 (27.60)	5.90 (.232)	6.60 (.260)	6.40 (.240)	5.40 (.213)
Standard Contacts	42817-0031	8 AWG	1.087 (27.60)	6.00 (.236)	5.50 (.216)	7.42 (.292)	5.83 (.229)
Grounding Contacts	42817-0111	10 and 12 AWG	1.165 (29.60)	5.90 (.232)	6.60 (.260)	6.40 (.240)	5.40 (.213)
Grounding Contacts	42817-0131	8 AWG	1.165 (29.60)	6.00 (.236)	5.50 (.216)	7.42 (.292)	5.83 (.229)