

## FEATURES AND SPECIFICATIONS

## Features and Benefits

- Wire-to-wire plug for panel-mounted or free-hanging applications
- Available with and without panel mounting ears
- Positive housing locks to mate with Mini-Fit, Jr. receptacle
- Fully isolated terminals to protect contacts from damage
- Uses standard Mini-Fit series terminals

## Reference Information

Product Specification: PS-5556-0001

Packaging: Tray or bag

UL File No.: E29179

CSA File No.: LR19980

TUV License No.: R75142

Mates With: 5557 single row receptacle

Use With: 5558, 30490 or 44478 terminals

Designed In: Millimeters

## Mechanical

Contact Insertion Force: 1.5kg max.

Contact Retention to Housing: 3.0kg min.

Wire Pull-Out Force: 9.0kg min.

Insertion Force to PCB: 5.0kg max.

Mating Force: 0.7kg (1.54 lb) max.

Unmating Force: 0.35kg (0.7 lb) min.

Normal Force: 200g min.

Durability: 30 cycles

## Physical

Housing: 6/6 nylon, UL 94V-2 or 94V-0

Contact: Brass or Phosphor Bronze

Plating: Tin, select Gold or overall Gold

Operating Temperature: -40 to +105°C

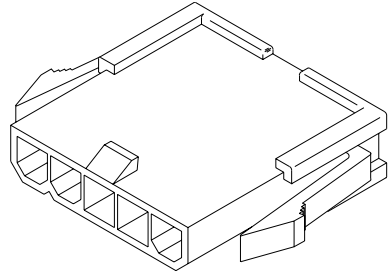
**4.20mm (.165") Pitch  
Mini-Fit, Jr.™  
Plug**
**5559****Single Row, With and Without Panel Mount Ears**

## CATALOG DRAWING (FOR REFERENCE ONLY)

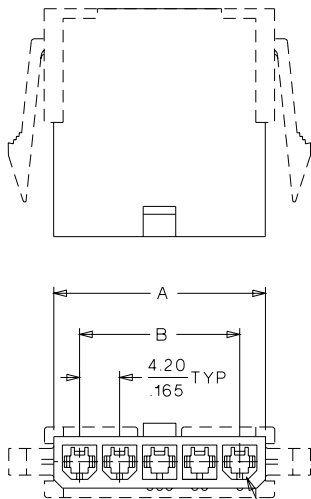

CIRCUIT 1

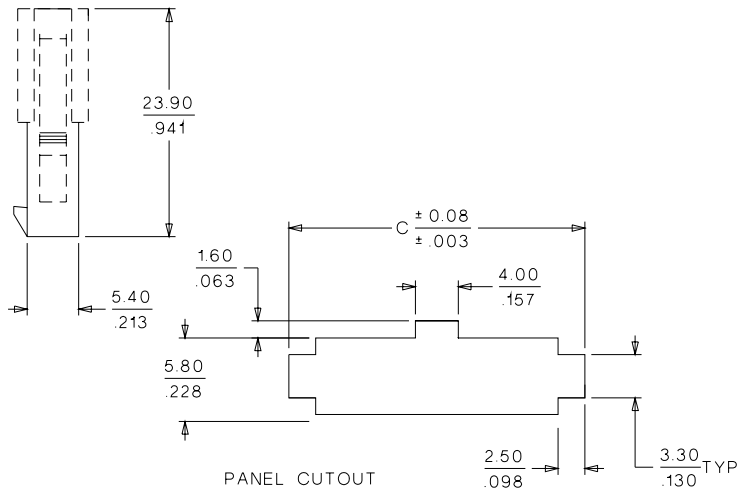

PANEL CUTOUT

MAX PANEL  $\frac{2.00}{.079}$   
THICKNESS .079

	<b>Order No.</b>
<b>Polarizing Key</b>	15-04-0211

## ORDERING INFORMATION AND DIMENSIONS

Circuits	Order No.				Dimension		
	Panel Mount		Free Hanging		A	B	C
	94V-2	94V-0	94V-2	94V-0			
3*	• 39-01-4032	• 39-01-4033	• 39-01-4036	• 39-01-4037	13.80 (.543)	8.40 (.331)	19.20 (.756)
4			• 39-01-4046		18.00 (.709)	12.60 (.496)	23.40 (.921)
5	• 39-01-4052	• 39-01-4053	• 39-01-4056	• 39-01-4057	22.20 (.847)	16.80 (.661)	27.60 (1.087)

• US Standard Product, available through Molex franchised distributors

\* 3-circuit plug designed for first-mate/last-break applications