

FEATURES AND SPECIFICATIONS

Features and Benefits

- Seal is in housing to simplify crimping process
- Raised body design provides polarization

Reference Information

Packaging: Chain or loose

Use With: [52116](#)

Designed In: Millimeters

Electrical

Voltage: 250V

Current: 3.0A

Physical

Contact: Phosphor Bronze

Plating: Tin

Wire Range: AVS 0.30 sq., CAVS 0.50 sq. (20 to 22 AWG)

Insulation Range: 1.50 to 1.90mm

Strip Length: 2.00 to 2.50mm



2.50mm (.098") Pitch Splash Proof Wire-to-Wire Crimp Terminal

50038

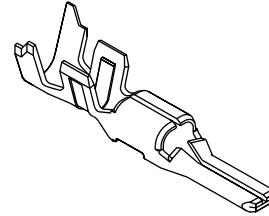

CATALOG DRAWING (FOR REFERENCE ONLY)

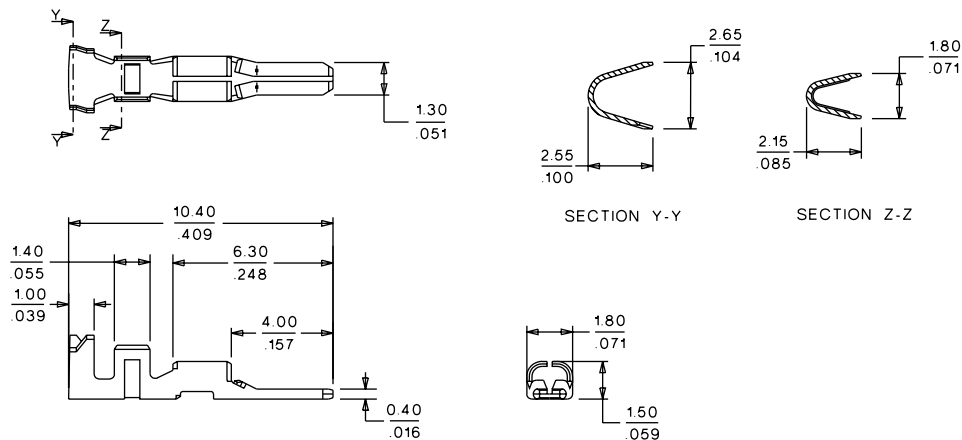

ORDERING INFORMATION

Order No.	Packaging
50038-8000	Chain
50038-8100	Loose