

FEATURES AND SPECIFICATIONS

Features and Benefits

- Unique spring-beam design provides high pressure and small deflection for high vibration applications
- Stabilizing bump at tip keeps terminal in place during mating

Reference Information

Packaging: Reel or bag

Use With: [52213](#)

Designed In: Millimeters

Electrical

Voltage: 25V

Current: AVSS/CAVS 0.50 sq. (20 AWG)—4.0A

AVSS/CAVS 0.30 sq. (22 AWG)—3.0A

Physical

Contact: Phosphor Bronze

Plating: Tin

Wire Range: AVSS/CAVS 0.30 sq., 0.50 sq. (20 to 22 AWG)

Insulation Range: 1.40 to 1.90mm

Strip Length: 2.00 to 2.50mm



2.50mm (.098") Pitch Splash Proof Wire-to-Wire Crimp Terminal

50148

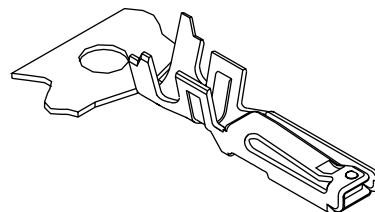

CATALOG DRAWING (FOR REFERENCE ONLY)

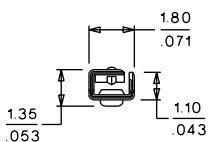
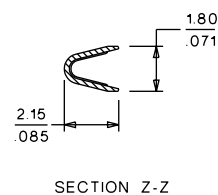
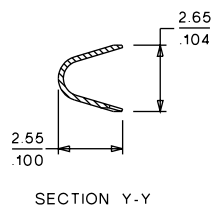
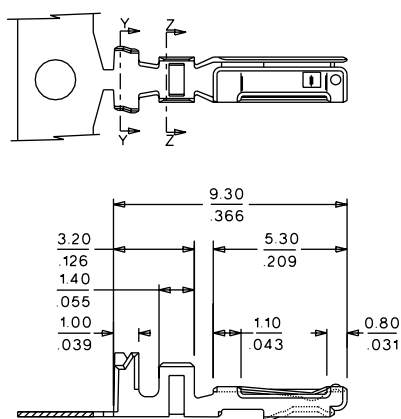

ORDERING INFORMATION

Order No.	Packaging
50148-8000	Reel
50148-8100	Bag