

## FEATURES AND SPECIFICATIONS

### Features and Benefits

- Size 2 circuits
- JIS D0203 S2 waterproof compliant
- Unique seal stopper design provides low insertion force
- For tight packaging applications
- User-friendly friction lock saves space and protects locking latch area
- Polarizing rib to ensure proper mating

### Reference Information

Packaging: Tray  
 Mates With: [52266](#)  
 Use With: [50148](#)  
 Designed In: Millimeters

### Electrical

Voltage: 25V  
 Current: 4.0A  
 Contact Resistance: 10mΩ max.  
 Dielectric Withstanding Voltage: 500V AC/1 min.  
 Insulation Resistance: 250 MΩ min.

### Physical

Housing: Black glass-filled PBTP  
 Cap: Glass-filled PBTP  
 Wire End Seal: Silicone  
 Operating Temperature: -40 to +105°C



# 2.50mm (.098") Pitch Splash Proof Wire-to-Wire Receptacle

## 52213

## 2-Circuit Version

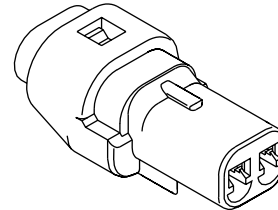

## CATALOG DRAWING (FOR REFERENCE ONLY)

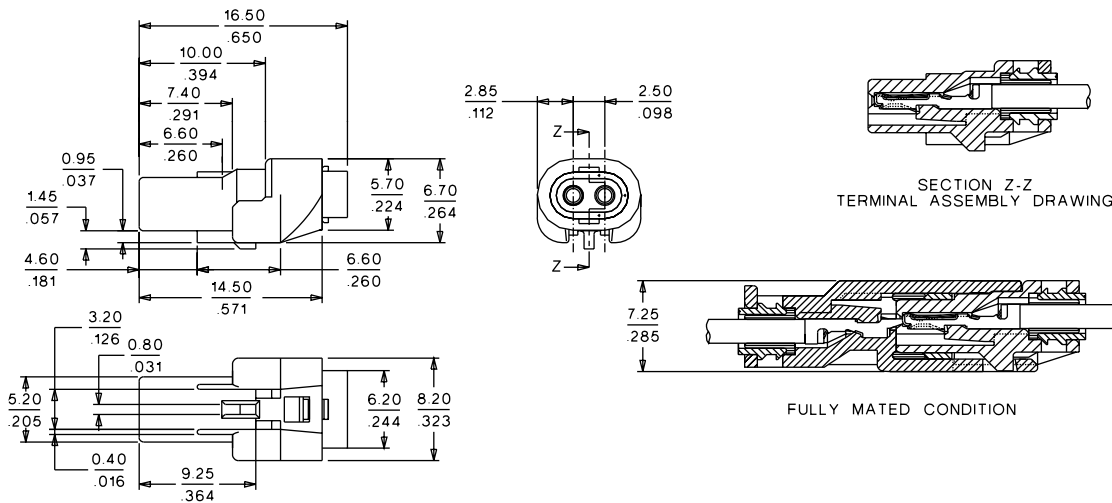

## ORDERING INFORMATION

Circuits	Order No.
2	52213-0211