

UNINSULATED TABS FOR PANEL/CHASSIS MOUNTING

GST-00, GST-0, GST-0-2.8/6.3

Variable Spacing - poles

[Print this page](#)

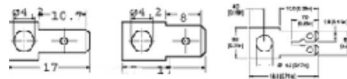

[Distributor stock check](#)

[additional photos](#)

[view 3d model](#)

TECHNICAL INFORMATION

APPROVAL INFORMATION

HOW TO ORDER

Description

These tabs are attached directly to equipment, e.g. as an earth terminal, and are suitable for receptacles according to DIN 46247, with the nominal sizes 2.8, 4.8 or 6.3 x 0.8.

Technical Data

Nominal Cross Section: 2.8 mm² (4340 mils²)

Bill of Materials

Tabs: Nickel plated copper alloy Tab widths: 2.8 mm/6.3 mm (0.110 in./0.250 po), 4.8 mm (0.187 po) and 6.3 mm (0.250 po)

Visual Description

4.8 mm tab

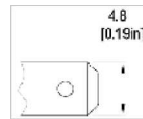

6.3 mm tab

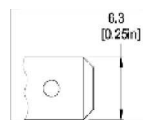

2.8/6.3 mm tab

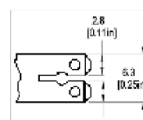

RoHS WEEE Pb free surface compliant



Please fill in the How to Order box

- ☐ Request Sample
- Quantity
- ☐ Request Quote
- Quantity

GST

Tab Size:

Select one

OPTIONS:

-- No option for this product --

ADD TO CART