

## ISO-900, Insulation Sockets

Variable Spacing - poles

[Print this page](#)

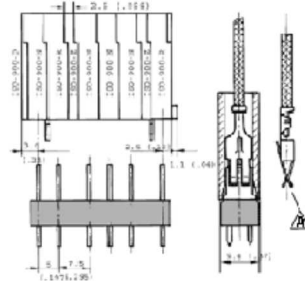

[Distributor stock check](#)

[view 3d model](#)

### TECHNICAL INFORMATION

### HOW TO ORDER

#### Description

ISO-900 insulated sockets are supplied to provide safe and efficient connections of double spring timer contacts. Sockets slide together to provide the needed number of poles; spacing between sockets is 5 mm (0.197 in.) but ISO-900-Z spacers provide 7.5 mm (0.295 in.) spacing. The ISO-900-R socket is equipped with special dovetail prongs which slip into the empty spaces in the 900 strip and resist accidental disconnection. The ISO-900-D end plate covers the last socket in a socket assembly. A combination of the 3 available spacings can be used to prevent a possible mismatch between the 900 block and the ISO-900 sockets. The double spring contacts click into the ISO-900 socket and indicate that a proper connection has been made. The empty chambers of the 900 terminal strip can be blocked with ISO-900-K keying pins; the prongs of the ISO-900-R socket cannot be inserted when keying pins are used. This provides an even greater degree of safety.

For insulation of double spring timer contacts

For series 900 tab connectors

WECO does not produce the double spring timer contacts, however, we recommend the following suppliers:

AMP: Timer Contacts 925612-2, 925613-2

Molex: Maxi-T Terminals 90021

Stocko: 6.3 mm Receptacles RFB 7979.00X

#### Technical Data

**Center to Center Spacing:** 5 mm (0.197 in.)/n7.5 mm (0.295 in.)/n10 mm (0.394 in.)

double spring timer contacts

#### Bill of Materials

#### Visual Description

##### End Plate version D

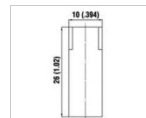

##### Keying Pin version K

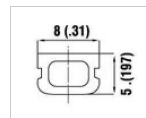

##### Insulation Socket Version N

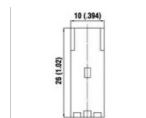

##### Spacer version Z

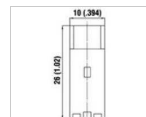

##### Insulation Socket with securing latches version R

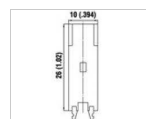

**Please fill in the How to Order box**

- Request Sample                      Quantity
- Request Quote                      Quantity

**ISO-900**

**Version:**

Select one

**OPTIONS:**

- SM: Special Marking (please provide sketch)

ADD TO CART